

QuikRead go[®] easy CRP

Allow the control to stabilize for **30 minutes at room temperature** before use.

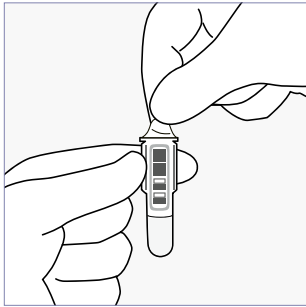

1 Remove the foil cover from the cuvette. Do not touch the clear flat surfaces in the lower part of the cuvette.

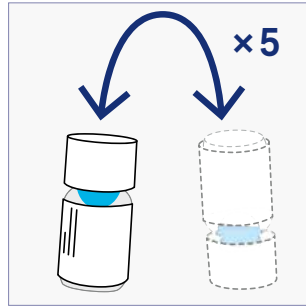

2 Mix the control vial **gently** by inverting 5 times. **Do not shake** to prevent foaming! In case a film appears on top of the vial, wait until it bursts or carefully remove it with a corner of lint-free paper.

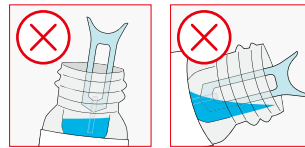
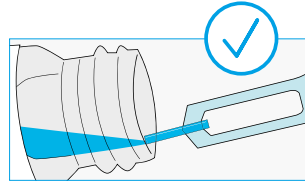

3 Tilt the control vial until the control solution reaches the bottleneck. Place the sample collector almost horizontally just **below the control surface at the mouth of the vial**. Fill the capillary part of the sample collector completely.

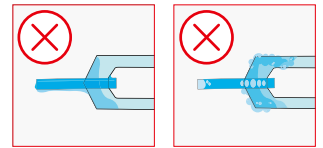
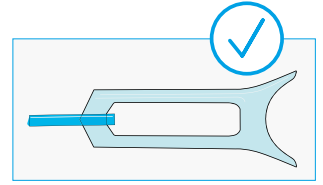

Note! Do not place the sample collector in the foam or inside the control vial. If there is excess sample or air bubbles on the sample collector, discard it and take a new sample. Do not wipe the sample collector.

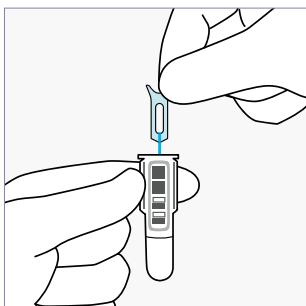

4 Insert the sample collector into the cuvette within 2 minutes.

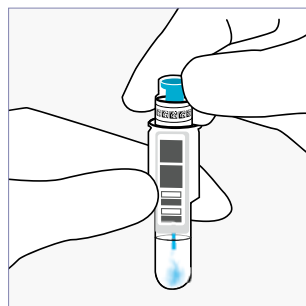

5 Close the cuvette tightly with the easy CRP reagent cap. Do not press down the turquoise inner part of the reagent cap. **Perform the test within 15 minutes.**



6 Choose **Quality control** on the display of the QuikRead go Instrument. Insert the cuvette into the measurement well of the instrument. The barcode should be facing you.

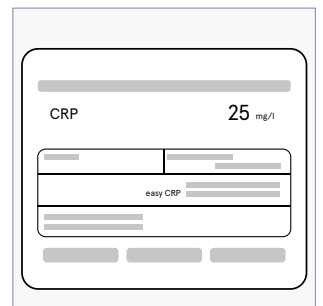

7 The result appears on the display and the cuvette rises up automatically when the measurement is completed. The acceptance limits of the control are in the labelling.